

Orca (YG80)

Weatherproof Lock



The Orca is the foremost high-strength lock designed for securing gates, roller doors, shipping containers, and any other large door or entryway.

Alongside the Orca's impressive physical attributes, its ability to integrate into an access control system is what elevates it beyond anything available in the market.

Fully monitored, weatherproof, and user configurable, the Orca is the perfect indoor and outdoor locking solution.



FEATURES

High Security

With an 18mm diameter stainless steel bolt pin and reinforced strike design, the Orca has a holding force in excess of 50,000N. The mounting bolts for the lock are concealed under the lock's cover, which can't be removed without triggering the tamper detection monitor.

Weatherproof

The Orca has been designed from the ground up with weatherproofing as a critical feature. With an IP67 certified design, E-coated aluminium lock body and strike for excellent corrosion resistance, and a built-in heater for continued functionality in colder climates, the Orca can handle any environment it is placed in.

Complete Monitoring

The Orca has a range of output signals - bolt locked and unlocked position, door position, and tamper detection.

Low Current Consumption

With the heater disabled, the Orca will draw as little as 30mA in standby, and only 300mA in operation at 12VDC.

Integrated Access Control

With user selectable fail safe / fail secure modes, three user selectable control methods, and multiple attempts to lock or unlock, the Orca is ready for a wide range of application requirements and can be integrated with many access control or alarm systems.

Versatile Installation

A symmetrical design means the Orca can be installed both horizontally and vertically, in indoor and outdoor environments. The included three metre flying cable ensures easy connection for all the monitoring, control, and the 12-24VDC power supply.

SPECIFICATIONS

Door Gap

15mm maximum

Static Strength

50,000 newtons (5,000Kg)

Dynamic Strength

200 joules (factory tested to UL 1034 standard)

Endurance

Cycle tested to 300,000 operations

Bolt Pin

ø18mm, 30mm extension, ø28mm receiver

Voltage at Lock

12 - 24VDC ±15%

Current Usage

Standby: 40mA@12V, 30mA@24V

Maximum: 1.0A@12V, 0.5A@24V,
2.0A@24V with heater on

Monitor Switch Ratings

24VDC, 0.25A

Materials

Lock / Strike Body: Aluminium 383

Bolt Pin: Stainless Steel 304

Strike Ring: UV Stabilized ABS

Compliance and Certification

CE Compliant, RoHS 2 Compliant

FCC Part 15 / ISED Compliant

IP67 Ingress Protection

Grade 4 Corrosion Resistance (EN 1670:2007)

Cold Operation -35°C (EN 60068-2-1:2007)

Dry Heat Operation +70°C (EN 60068-2-2:2007)

Lock Variants

YNL300A – Lock with Strike

Accessories

YNL303A – Strike

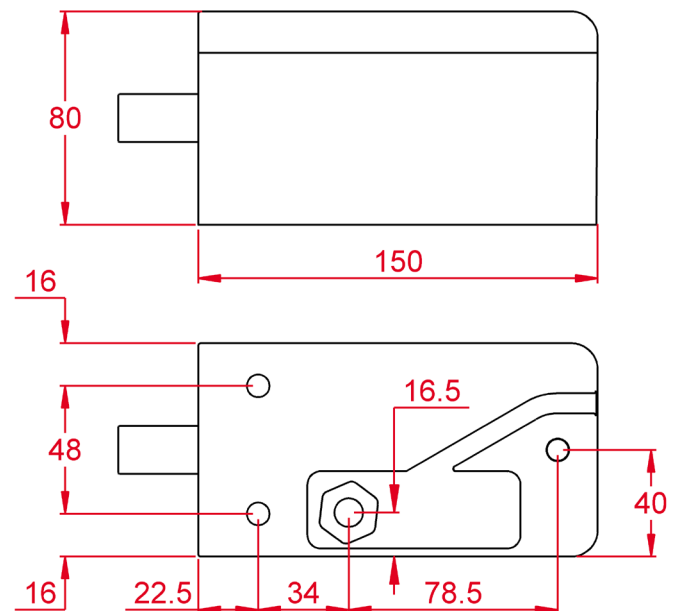
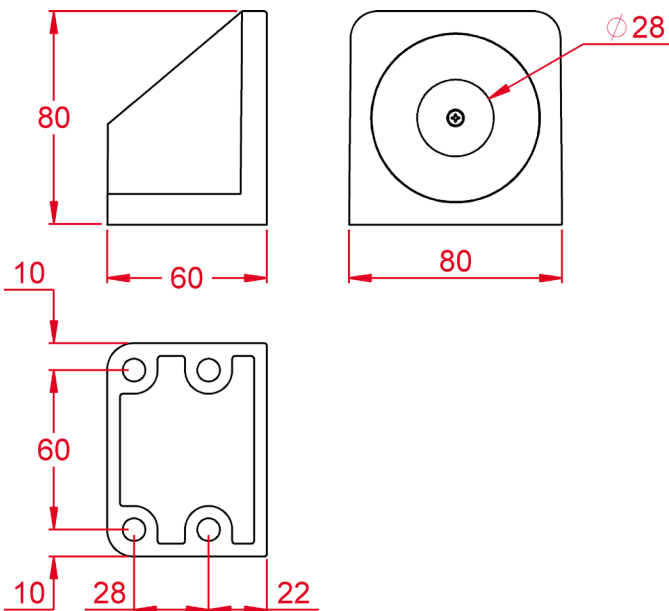

Drawings are not to scale. Dimensions are in millimetres (mm).



Contact lock.sales@theavagroup.com to be put in touch with your local representative.

www.bqtsolutions.com