

YD25L

Solenoid Dropbolt



The YD25L is a solenoid driven electronic lock for pedestrian doors that comes with a unique latching device designed to help alleviate door alignment and door rattle concerns.

The slim profile of the lock allows for installation in most door types while an optional mounting kit allows for surface fitting when preferred.

Monitoring outputs and on-board intelligence come as standard and the magnet latching mechanism make it a great solution for swing through doors.



FEATURES

Alignment

The YD25L has a built-in magnet latch, which ensures the correct positioning of the lock and strike every time. Perfect for swing through doors, rattling doors, or misaligned doors.

High Security

With a stainless steel bolt pin, the YD25L has a holding force in excess of 10,000N. On-board control provides auto-relock and timed relock for added security.

Reliability

The durable design of the Solenoid Dropbolt range has made it one of the most reliable electromechanical locks in the world, rated to 1,000,000 cycles.

Complete Monitoring

The YD25L can output both the bolt position and the door position as monitor signals.

Low Current Consumption

The YD25L will draw as little as 80mA holding current using the built-in current reduction circuitry.

Integrated Access Control

With factory set fail safe and fail secure variants, and multiple attempts to lock or unlock, the YD25L is ready for a wide range of application requirements and can be integrated with many access control or alarm systems.

Versatile Installation

With the included fitting tabs the YD25L can be morticed flush into both the side and top of many door frames. Optional housing and dress plate allow for surface mounting the lock and strike for an even wider range of applications, including installation on glass doors.

SPECIFICATIONS

Door Gap

6mm maximum

Static Strength

10,000 newtons (1,000Kg)

Endurance

Cycle tested to 1,000,000 operations

Bolt Pin

ø12.7mm, 16mm extension, ø15.5mm receiver

Alignment

Built-in magnet latch mechanism

Voltage at Lock

12 - 24VDC ±10%

Current Usage

Holding: 130mA@12V, 80mA@24V

Maximum: 1.5A@12V, 1.4A@24V

Monitor Switch Ratings

24VDC, 0.5A

Materials

Lock / Strike Plate: Stainless Steel 304

Bolt Pin: Stainless Steel 304

Compliance and Certification

CE Compliant, RoHS 2 Compliant

FCC Part 15 Compliant

Lock Variants

YNL131E – Fail Safe Lock
with Long Strike Plate

YNL132E – Fail Secure Lock
with Long Strike Plate

Accessories

YNL133E – Long Strike Plate

YNL104J – Housing

YNL106J – Dress Plate

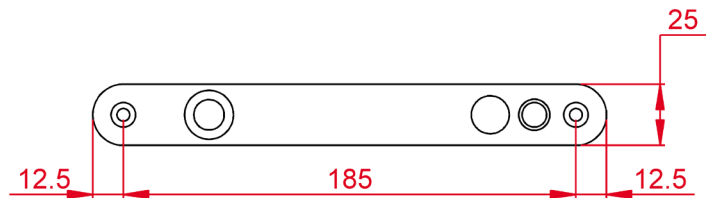
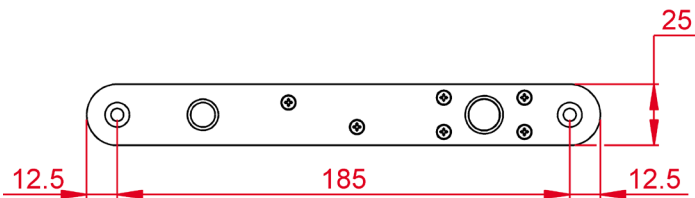
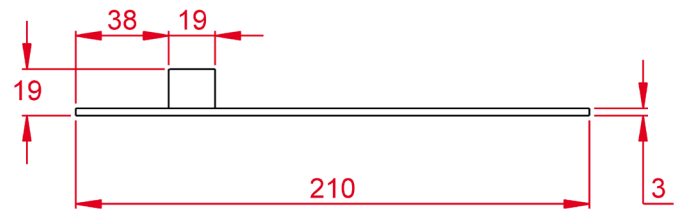
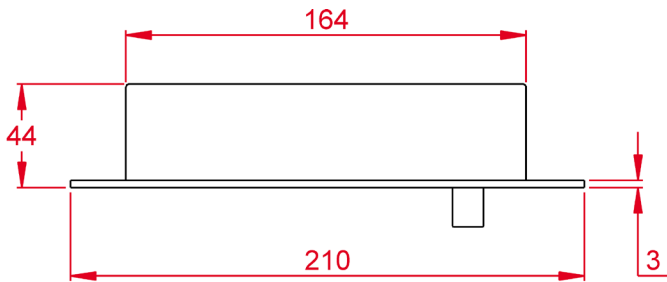

Drawings are not to scale. Dimensions are in millimetres (mm).



Contact lock.sales@theavagroup.com to be put in touch with your local representative.

www.bqtsolutions.com