

RFID WALL READER BT950



Product Overview

The BT950 reader is stylish as well as functional. Its low profile and slimline shape allow for easy installation on door architraves or mullions where larger readers will not fit. It can be mounted directly on a metal door frame with no adverse effect on the reader's function. In addition, the BT950 is available in a range of secure options right up to military grade technology and encryption and provides a flexible solution through customisation to suit all access control requirements. This standard footprint mullion MIFARE smart card reader can be purchased pre-configured or customised and will integrate seamlessly with existing systems to facilitate upgrading to higher security technology.

Why BQT Solutions

BQT Solutions is a specialist in the development, manufacture and supply of high quality, high security card and biometric readers, electromechanical locks and related electronic security products. Providing high security solutions to verticals such as Airports, Hospitals, Prisons and Government for over 35 years.

Innovating today for a more secure tomorrow

Product Benefits

Benefit One

Its narrow design offers an aesthetically pleasing, non-obstructive reader that takes up less physical space than traditional cases while being engineered with robust materials to provide effective access control in the most challenging environments.

Benefit Two

Offering pre-configured and customised operations, the BT950 can be set up to accept your custom key and data formats and is designed to work with your pre-existing security configurations.

Benefit Three

The BT950 offers installation flexibility and integration with many existing access panels and can be customised to suit a proprietary system. When you receive your reader, all you will have to do is connect them in to secure your site with your existing access control system.

PRODUCT FEATURES

Compatibility

Available with MIFARE Classic and DESFire proximity cards for contactless smart card technology. The BQT Solution's suite of MIFARE Classic & DESFire readers and smart cards, opens the gateway to multiple security applications, including access control, biometric authentication, IT security, e-purse, e-vending, time, and attendance to ensure your security needs are being met.

Robust Design

Its sleek casing offers a robust exterior designed to withstand tampering and maintain integrity during a security threat or incident. Built to withstand common reader threats, including excessive force from a hammer or heavy tool, the BT950 will continue to operate and secure access even after being damaged.

Low Power

The BT950 uses power when needed but goes into a standby mode when not in use. Low power paired with high-security access control makes the BT950 reader a preferred product choice for many industry leaders by offering an eco-friendly and economical, yet secure solution.

Tamper Monitor

Security threats aren't always captured on camera and pose a real risk to unauthorised access. We know the peace of mind many organisations need when it comes to alerting them to security threats and the BT950 offers a tamper monitor that will alert the security team if there has been a breach attempt at one of the readers

Secure Encryption

Working with your current system, the BT950 offers flexible access control, with the option to use Wiegand, OSDP or Encrypted RS485 access data output. The BT950 additional benefits of being cost-effective and easy to wire and deploy across your sites where different levels of encryption are needed for secure access control.

PRODUCT APPLICATIONS

New sites looking for a narrow, aesthetically pleasing reader that has a need for high usage contactless access control. The BT950 is available in several technology levels for all security requirements and is the ideal slimline reader for all market sectors.



SPECIFICATIONS

- **Voltage at Reader**
8VDC to 16VDC
- **Current Usage**
Average: 80mA
Peak: 160mA
- **Card Read Range**
20mm to 40mm (0.8" to 1.6")
- **Operating Temperature**
-25°C to +65°C (-13°F to +149°F)
- **Relative Humidity (% max)**
90%, operating non condensing
- **Reader Dimensions**
119mm (4.69") X 43mm (1.69")
X 23mm (0.91")
- **Materials**
Reader / Shroud Body: ABS
Plastic
Colour Finish: Charcoal
- **Feedback**
Green/Red LED, with external control
Buzzer, with external control
Tamper detection, optional output
- **Credential Options**
ISO14443A, MIFARE Classic®
1K/4K, MIFARE Plus® X
2K/4K, MIFARE® DESFire®
EV1 4K/8K, MIFARE®
DESFire® EV2 4K/8K,
MIFARE® DESFire® EV3
4K/8K
- **Compliance and Certification**
FCC, CE, UKCA, RCM, RoHS,
IP65
- **Reader Variants**
BT950-1 – CSN Reader
BT950-2 – miPASS2 Reader
BT950-3 – Custom MIFARE
Classic Reader
BT950-4 – miPASS3 Reader
BT950-5 – miPASS4 Reader
BT950-6 – Custom MIFARE
DESFire Reader
- **Accessories**
B4015G000000 – BT95X
Tamper Plate
B4104G000000 – BT95X
Replacement Shroud

DIAGRAM - BT950

Diagrams are not to scale. Measurements are in millimeters (mm).

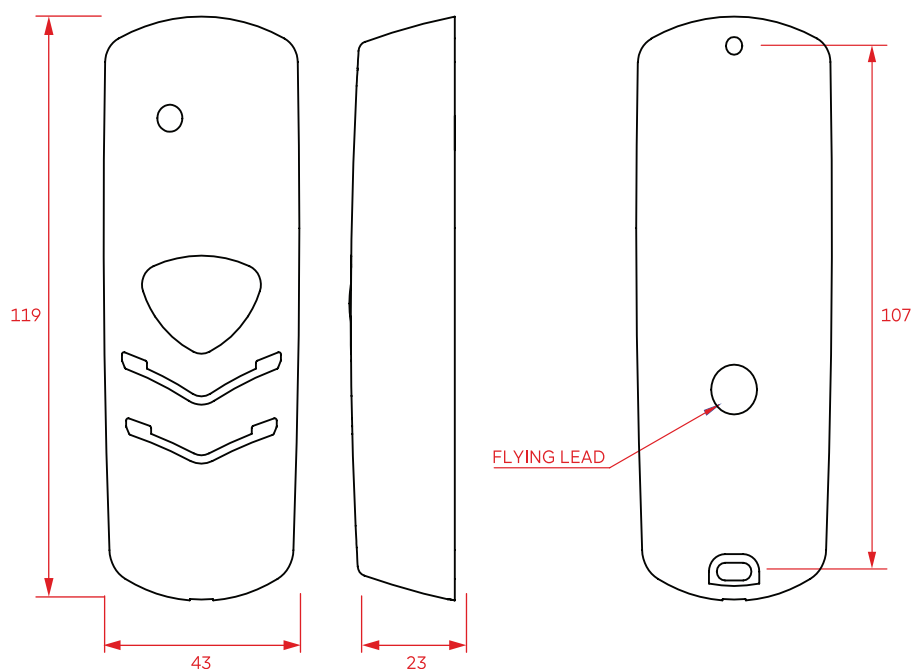

MODEL COMPARISON

NAME	APPLICATION	OUTPUT PROTOCOLS	OPERATING TEMPERATURE	READER DIMENSIONS	POWER USAGE
BM680	Sites that are cost sensitive yet still require high security	Wiegand, OSDP, RS485	-25°C to +65°C (-13°F to +149°F)	85mm X 43mm X 22mm (3.35" X 1.69" X 0.87")	8VDC to 16VDC, 60mA (Average), 160mA (Peak)
BT930	Existing sites looking to upgrade the technology within the same architrave footprint	Wiegand, OSDP, RS485	-25°C to +65°C (-13°F to +149°F)	140mm X 47mm X 24mm (5.51" X 1.85" X 0.94")	8VDC to 16VDC, 60mA (Average), 160mA (Peak)
BT950	Installations that require a robust standard form architrave reader	Wiegand, OSDP, RS485	-25°C to +65°C (-13°F to +149°F)	119mm X 43mm X 23mm (4.69" X 1.69" X 0.91")	8VDC to 16VDC, 80mA (Average), 160mA (Peak)
BT951	Any site wanting to migrate from 125KHz (FSK) to MIFARE security	Wiegand, OSDP, RS485	-25°C to +65°C (-13°F to +149°F)	119mm X 43mm X 23mm (4.69" X 1.69" X 0.91")	8VDC to 16VDC, 120mA (Average), 300mA (Peak)
BT953	Any site wanting to migrate from 125KHz (PSK) to MIFARE security	Wiegand, OSDP, RS485	-25°C to +65°C (-13°F to +149°F)	119mm X 43mm X 23mm (0.91" X 4.69" X 1.69")	8VDC to 16VDC, 120mA (Average), 300mA (Peak)
BT815	Sites needing a standard form gang box reader	Wiegand, OSDP, RS485	-25°C to +65°C (-13°F to +149°F)	90mm X 90mm X 20mm (3.54" X 3.54" X 0.79")	8VDC to 16VDC, 60mA (Average), 160mA (Peak)
BT817	Sites requiring dual factor authentication or cardless access	Wiegand, OSDP, RS486	-25°C to +65°C (-13°F to +149°F)	90mm X 90mm X 28mm (3.54" X 3.54" X 1.10")	8VDC to 16VDC, 90mA (Average), 190mA (Peak)
BT853	Sites requiring dual factor authentication or cardless access and on device feedback	Wiegand, OSDP, RS487	-25°C to +65°C (-13°F to +149°F)	157mm X 97mm X 50mm (6.18" X 3.82" X 1.97")	8VDC to 16VDC, 90mA (Average), 190mA (Peak)
BT51X	Installations requiring a discrete yet secure device, ideal for Hospitals and Prisons	Wiegand, OSDP, RS488	-25°C to +65°C (-13°F to +149°F)	Variable, to suit	8VDC to 16VDC, 180mA (Average), 240mA (Peak)

WARRANTY

Unless specified otherwise, the Company warrants to the Customer that 'BQT Solutions Branded Products' (excluding third party products and software) are covered by a return to base warranty on defects in materials and workmanship affecting normal use for a period of the Warranty offered under the Standard Terms and Conditions of Sale from BQT invoice date ('Standard Warranty')

Information obtained in this document is subject to change without notice. For further technical or sales information, visit our website at www.bqtsolutions.com or email support@bqtsolutions.com